

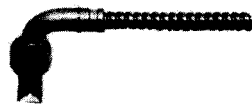

48PT1



48PT2

45CM1



69ND1

# FIREYE® FLAME SCANNERS

INFRARED: 48PT1 and 48PT2

PHOTOCELL: 45CM1

FLAME ROD: 69ND1

For UV self-check scanners use SC101

For non self-check UV Scanners use SC102

**Year 2000 Compliant in accordance with BSI document DISC PD2000-I:1998**

## DESCRIPTION

### 45CM1

The 45CM1 photocell scanner with #922 cell and Rajah stud terminal is designed for use in the blast tube on conventional pressure atomizing oil burners.

### 48PT1

The 48PT1 lead sulfide infrared scanner contains a high impedance detector and is designed to be used only on P-Series controls.

### 48PT2

The 48PT2 lead sulfide infrared scanner contains a low impedance detector and is designed to detect low flicker frequency IR signals from gas and light oil flames. It is designed for use on DSeries, Flame-Monitor, FlameWorx and MicroM controls.

### 69ND1

The 69ND1 flame rod is made of high temperature resistant metal and can be used only to detect gas flames. The rods come in 12, 18 and 24 inch lengths.



**CAUTION: Fireeye scanners are for use only with Fireeye controls. Do not connect Fireeye scanners with controls not manufactured by FIREYE.**



**CAUTION: If component checking is required during burner operation for constantly fired burners, utilize the infrared flame scanner (48PT2) with associated AutoCheck amplifier. For Flame-Monitor systems use the EIR1, EIR3 or EIR2 and for MicroM systems use the MEIR1 or MEIR4.**

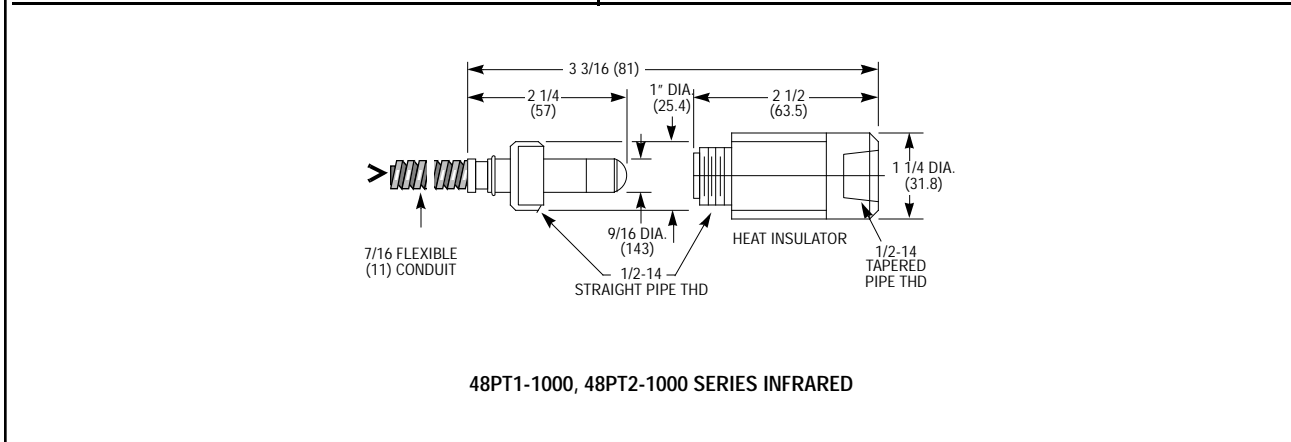
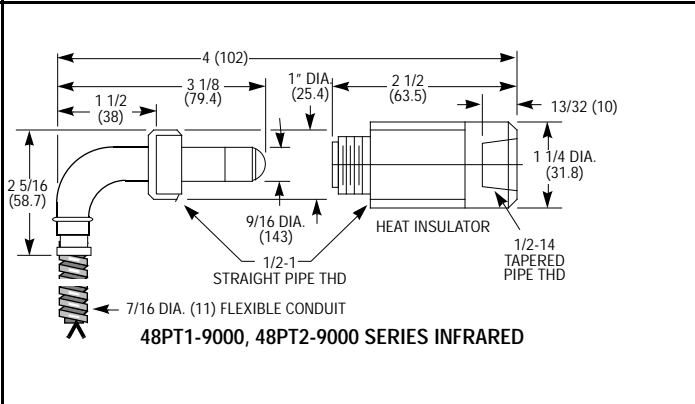
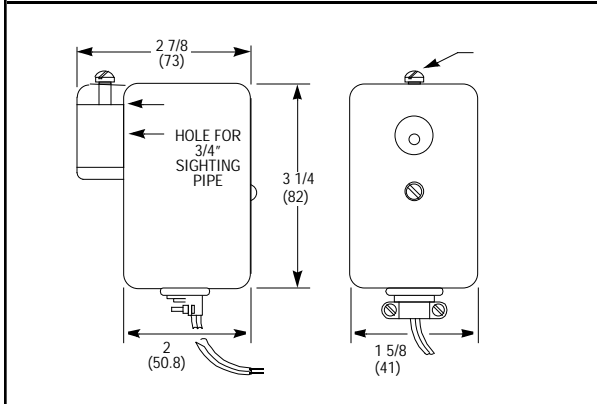
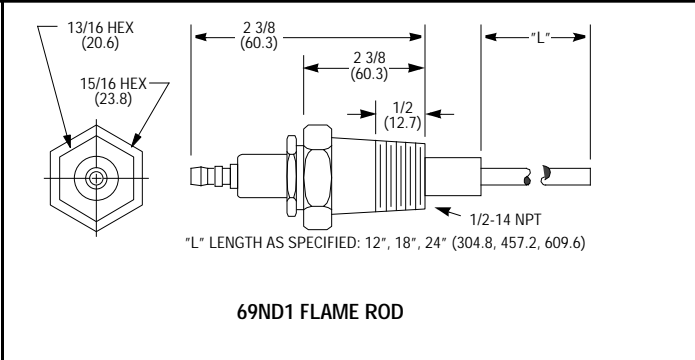
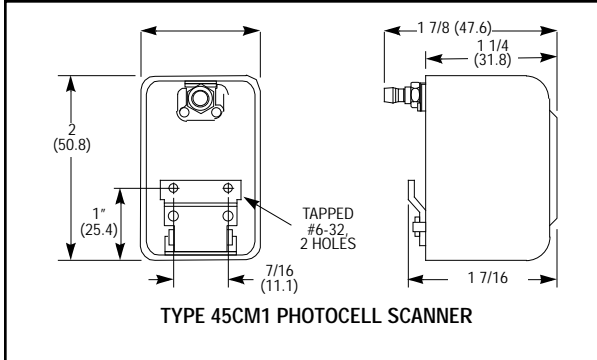

Scanner Model	Type	Approx. Volts Across Cell	Approx. Res.* of Cell	Ambient Temp. Limits
45CM1	Photocell	280-305 VAC	Infinite	165°F/74°C, -40°
48PT1	Infrared	125VDC	1.5 Meg. ohms	140°F/ 60°C, -40°
48PT2	Infrared	7-15VDC	20K - 80K ohms	140°F / 60°C, -40°
69ND1	Flamerod	280-305 VAC	Infinite	Tip 2460°F 1500°F/816°C, -40°

\* Resistance measured with 20K Ohms/ Volt Meter  
For proper Flame Signal Voltage see technical bulletin for the appropriate control.



DESCRIPTION	USE WITH
IR Straight Head 8 feet (2440mm) leads IR Straight Head 4 feet (1220mm) Leads IR 90 deg. Head 8 ft. (2440mm) Leads IR 90 deg. Head 4 ft. (1220mm) Leads - 9007 Water Repellant	P-Series
IR Straight Head 8 feet (2440mm) leads IR Straight Head 4 feet (1220mm) Leads IR 90 deg. Head 8 ft. (2440mm) Leads IR 90 deg. Head 4 ft. (1220mm) Leads - 9007 Water Repellant	C & D Series P-Series FLAME-MONITOR MicroM
Heat Insulator for 48PT Scanners	
Flame Rod 12 inches (305mm) 1/2 in. mount Flame Rod 18 inch (460mm) 1/2 in. mount Flame Rod 24 Inches (710mm) 1/2 in. mount Photocell Scanner with filter Photocell Scanner without filter	C, D, M-Series MB Systems FLAME-MONITOR MicroM