



BALANCED PRESSURE THERMOSTATIC STEAM TRAP

MODEL FL21/FL32 **QuickTrap**[®]

UNIVERSAL BALANCED PRESSURE THERMOSTATIC TRAP WITH “FAIL-OPEN” DESIGN

Benefits

Inline replaceable and cleanable 2-bolt universal flange steam trap with high air venting capability. For steam mains, tracers and light process.

1. Two-bolt flange connector permits trap replacement or cleaning in minutes.
2. Patented “fail-open” design for critical service.
3. “Pressure-to-close” valve design with hardened stainless steel valve head and seat for maximum life.
4. Valve, four diaphragms and casing have matching contours for high superheat capability and water hammer resistance.
5. Flat mirror-finish valve head provides tightest sealing for energy efficiency and life.
6. Pipeline screen located in connector protects and keeps trap module replacement costs low.
7. Easily cleanable and repairable design with replaceable module gaskets lowers maintenance costs.



Specifications

Model	FL21			FL32		
	Screwed	Socket Weld	Flanged	Screwed	Socket Weld	Flanged
Connection						
Size (in)	1/2, 3/4, 1	1/2, 3/4, 1	1/2, 3/4, 1	1/2, 3/4, 1	1/2, 3/4, 1	1/2, 3/4, 1
Max. Operating Pressure (psig) PMO	300			450		
Min. Operating Pressure (psig)	Vacuum					
Maximum Back Pressure	90% of inlet pressure					
Max. Operating Temperature (°F) TMO	see graph at right					
Max. Allowable Pressure (psig) PMA	450					
Max. Allowable Temperature (°F) TMA	572					
Subcooling of X-element Fill (°F)	up to 11					
Type of X-element	B					

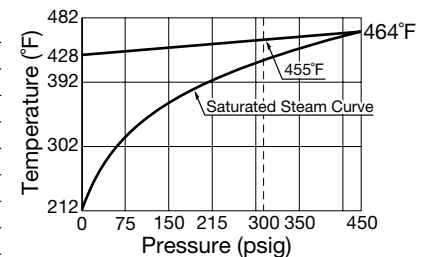

Connections and sizes in bold are standard



To avoid abnormal operation, accidents or serious injury, DO NOT use this product outside of the specification range. Local regulations may restrict the use of this product to below the conditions quoted.

No.	Description	Material	ASTM/AISI*	JIS
① ^T	Trap Body	Cast Stainless Steel	A351 Gr.CF8	SCS13A
②	Connector Body	Cast Stainless Steel	A351 Gr.CF8	SCS13A
③ ^T	Connector Flange	Carbon Steel	A105	—
④ ^T	Snap Ring	Carbon Steel	AISI1055	SWRH57
⑤ ^{MR}	Outer Connector Gasket	Stainl. St./Graphite	AISI304	SUS304
⑥ ^{MR}	Inner Connector Gasket	Stainl. St./Graphite	AISI304	SUS304
⑦ ^{RT}	Valve Seat	Stainless Steel	AISI420F	SUS420F
⑧ ^T	Trap Cover	Carbon Steel	A105	—
⑨ ^{MR}	Cover Gasket	Stainl. St./Graphite	AISI316L	SUS316L
⑩	Connector Screen	Stainless Steel	AISI430	SUS430
⑪ ^{MR}	Screen Holder Gasket	Soft Iron	AISI1010	SUYP
⑫	Screen Holder	Carbon Steel	A105	—
⑬ ^{RT}	X-element	Stainless Steel	—	—
⑭ ^{RT}	X-element Guide	Stainless Steel	AISI304	SUS304
⑮ ^T	Nameplate	Stainless Steel	AISI304	SUS304
⑯ ^{RT}	Spring Clip	Stainless Steel	AISI304	SUS304
⑰ ^T	Cover Bolt	Carbon Steel	AISI1045	S45C
⑱ ^{RT}	Trap Screen	Stainless Steel	AISI304	SUS304
⑲ ^T	Connector Bolt**	Alloy Steel	A193 Gr.B7	—
⑳	Flange***	Carbon/Cast Steel	A105/216 Gr.WCB	—

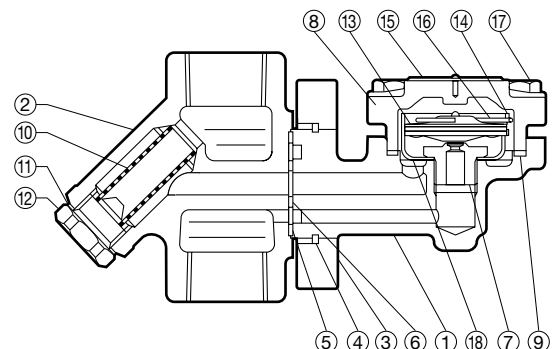

* Equivalent ** Shown on reverse *** Shown on reverse, material depends on flange specifications
Replacement kits available: (M) maintenance parts, (R) repair parts (T) trap unit L21/L32

Dimensions

● **FL21/FL32**
Screwed

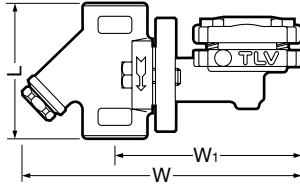

FL21/FL32 Screwed* (in)

Size	L	W	W ₁	Weight (lb)
1/2	3 1/8	6 5/16	4 1/8	4
3/4				4.6
1	3 3/4	7 1/4	4 5/16	4.6

* NPT, other standards available

● **FL21/FL32**
Socket Weld

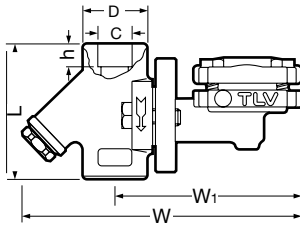

FL21/FL32 Socket Weld (in)

Size	L	W	W ₁	φD	φC	h	Weight (lb)
1/2	3 1/8	6 5/16	4 1/8	1 9/16	7/8	1/2	4
3/4					1 1/16		
1	3 3/4	7 1/4	4 5/16	1 13/16	1 3/8	9/16	4.6

● **FL21/FL32**
Flanged

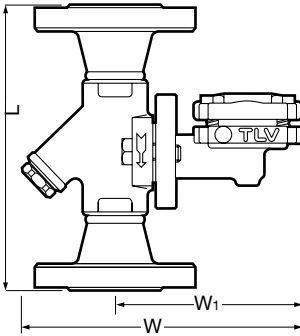

FL21/FL32 Flanged (in)

Size	L			W	W ₁	Weight* (lb)
	ASME Class					
	150RF	300RF	600RF			
1/2	5 1/2	5 1/2	5 1/2	6 5/16	4 1/8	11
3/4	6 1/2	6 1/2	6 1/2			12
1	8 1/4	8 1/4	8 1/4			14

Other standards available, but length and weight may vary
* Weight is for Class 600 RF

Discharge Capacity

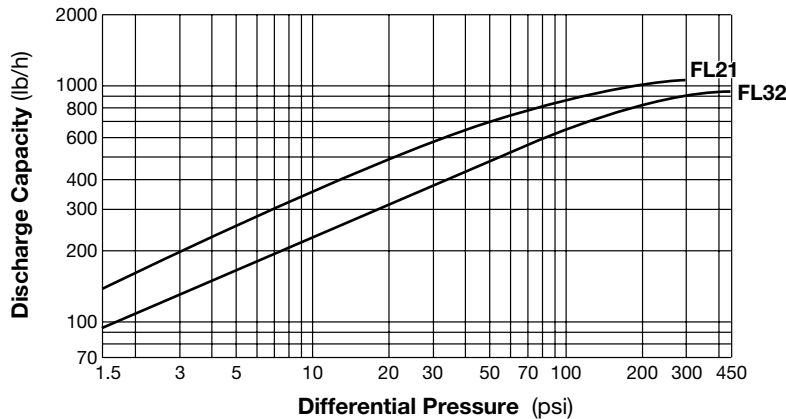

1. Differential pressure is the difference between the inlet and outlet pressure of the trap.
2. Recommended safety factor: at least 2.

TLV CORPORATION

13901 South Lakes Drive, Charlotte, NC 28273-6790
 Phone: 704-597-9070 Fax: 704-583-1610
 E-mail: tlv@tlvengineering.com
 For Technical Service 1-800 "TLV TRAP"



Manufacturer
TLV CO., LTD.
 Kakogawa, Japan
 is approved by LRQA Ltd. to ISO 9001/14001

ISO 9001/ISO 14001

